



Thanks for purchasing this genuine TSO Product.

Questions? Suggestions? Ideas? We thrive on your feedback! Contact us toll-free at 800-727-0311 (U.S.), 239-236-5526 (international), email us at info@tsoproducts.com, or visit www.tsoproducts.com/support for a copy of this guide.

⚠ DANGER

Danger indicates a hazardous situation that, if not avoided, will result in death or serious injury.

⚠ WARNING

Warning indicates a hazardous situation that, if not avoided, could result in death or serious injury.

⚠ CAUTION

Caution indicates a hazardous situation that, if not avoided, may result in minor or moderate injury or property damage.

★ PRO TIP

Notice indicates important or helpful information and/or user tips.

ESSENTIAL SAFETY WARNINGS

This product is intended only for use with compatible track saw guide rail systems. Users must adhere to all safety and operating instructions provided by the manufacturer of the associated track saw and guide rail, in addition to those contained within this TSO Products Parallel Guide System Gen 2 guide.

Before use, verify that all Parallel Guide System Gen 2 components are securely attached to the guide rail, and that the workpiece is securely affixed to a stable surface.

Failure to follow these instructions may result in tool damage, inaccurate cuts, serious injury, or death. TSO Products assumes no liability for damage or injury resulting from improper use, installation, or modification of this product.

⚠ CAUTION

This guide provides installation and setup instructions only for the TSO Products Parallel Guide System Gen 2 on compatible track saw guide rails. It does not provide instruction on the proper or safe operation of power tools, including track saws or other cutting equipment.

Users are responsible for understanding and following all safety, setup, and operational instructions provided by the manufacturer of any tools they use in conjunction with this system. Failure to do so may result in equipment damage, serious injury, or death.

TSO Products and the authors of this guide assume no responsibility or liability for injuries or damages resulting from improper use of power tools, misuse of this system, or failure to observe appropriate safety protocols.

Woodworking involves inherent risks. Always wear appropriate Personal Protective Equipment (PPE) and follow established safe work practices.

PARALLEL GUIDE SYSTEM GEN 2 USER GUIDE

Contents

Compatible Track Saw Systems	2
What's Included in the Box	2
Tools Needed for Setup	2
Additional Compatible Accessories	2
Assemble Parallel Guide Tracks	3
Attach Assembled Parallel Guides to Guide Rail	3
Fine-Tune Drop-Loc Connector to Guide Rail	4
Calibrating Flip Stop Pro	5
Installing the Guide Rail Square Connector	6
Questions, Comments, or Ideas?	6

Compatible Track Saw Systems

This system is compatible only with the track saw guide rails listed below:

- Festool® FS guide rails
- Makita® plunge saw guide rails
- Milwaukee® plunge saw guide rails
- RIDGID® track saw guide rails
- Kreg® Adaptive Cutting System guide tracks
- Powertec® track saw guide rails
- WEN® track saw guide rails

What's Included in the Box

Verify your kit includes the following universal parts:



Next, confirm you have the correct tracks for your kit:



Tools Needed for Setup

Beyond the included hex driver, the following tools may be helpful for initial calibration and setup:

- A trusted measurement instrument (e.g. combination square or double square)

Additional Compatible Accessories

The below accessories are available to expand your Parallel Guide System:

- [Extra Flip Stop Pros](#)—Keep multiple Flip Stop Pros on your Parallel Guide Tracks, pre-set for common dimensions, to save setup time between cuts.
- [Extra Parallel Guide Tracks](#)—Order standalone track pairs to expand your cut capacity in the future.
- [Narrow Stock Pro for Parallel Guide System](#)—A stable, accurate way to make narrow rips using the Parallel Guide System Gen 2 tracks.
- [Systainer Foam Insert for 20" Parallel Guide System Gen 2](#)—Store your entire 20" kit, including Flip Stop Pros and Drop-Loc Connectors, in a single Systainer.
- [Systainer Foam Insert for PGS Accessories](#)—Store and protect smaller system components, including the Narrow Stock Pro for PGS and [GRC-12 Guide Rail Connectors](#).
- [GRS-16 Connector](#)—Joins GRS-16 Guide Rail Squares to Gen 2 Parallel Guide Tracks.

Assemble Parallel Guide Tracks

Step 1. Slide the *Drop-Loc Connector* onto the machined end of the *Parallel Guide Track*, lining up the holes.

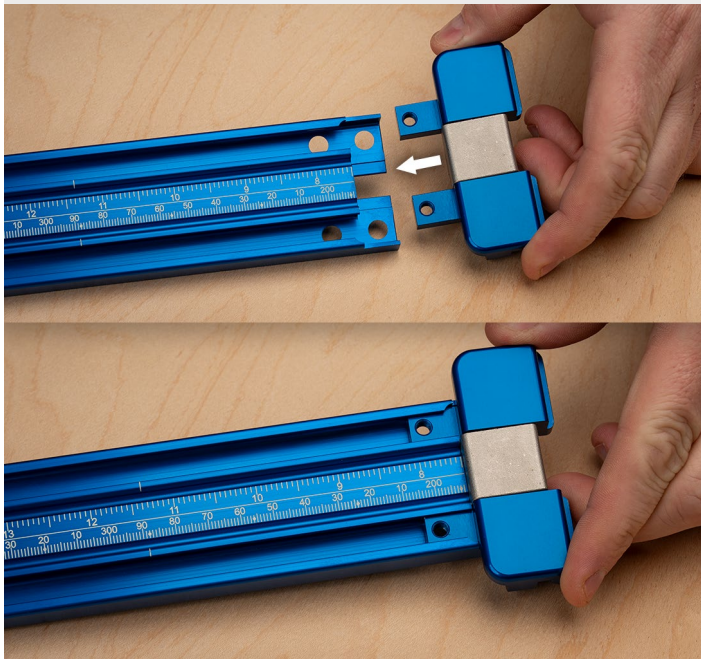

Step 2. Using the included *3mm Hex Driver*, attach the *Drop-Loc Connector* to *Parallel Guide Track* using four of the included *Flat Head Screws*. Ensure screw heads are flush or below the surface of the track. Hand tighten.

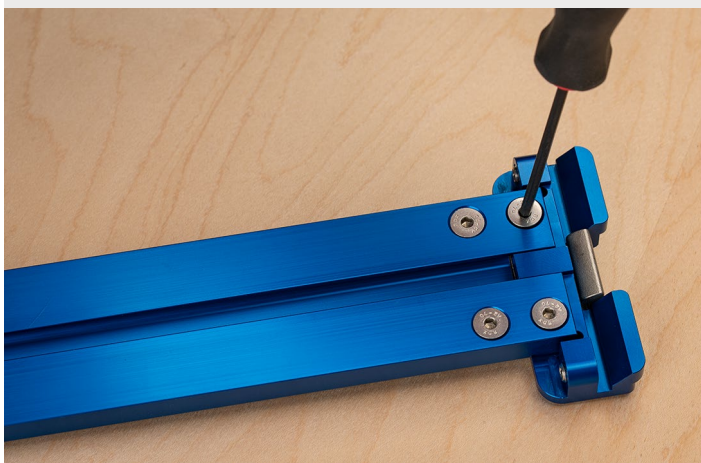

Step 3. Repeat Steps 1 and 2 for each additional *Parallel Guide Track*.

Attach Assembled Parallel Guides to Guide Rail

Step 1. Position assembled parallel guide so the *Drop-Loc Connector* is at a 30° to 45° angle with respect to your guide rail.



Step 2. Slide the stainless steel button forward and insert the legs of the *Drop-Loc Connector* into your guide rail T-track.

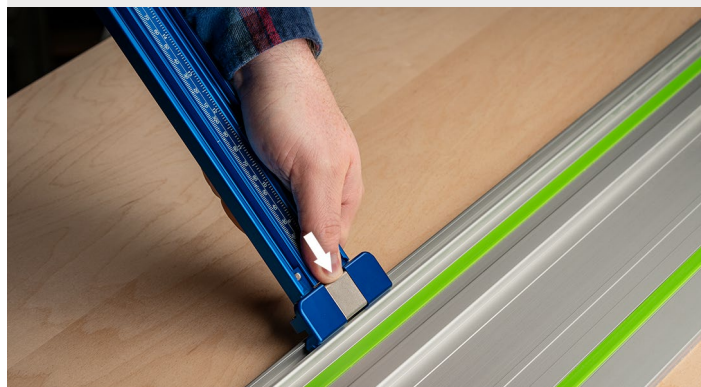

Step 3. Continuing to keep the button depressed, tilt the parallel guide downward until it lays flat. Once flat, release the button.



Step 4. Repeat for each additional *Parallel Guide Track*.

PARALLEL GUIDE SYSTEM GEN 2 USER GUIDE

TSO™ PRODUCTS

Fine-Tune Drop-Loc Connector to Guide Rail

The included *Drop-Loc Connectors* feature an innovative universal fitment across all compatible track saw guide rails. To accommodate variation in guide rails, a nylon-tipped adjustment screw is located on each side of the *Drop-Loc Connector*—allowing you to fine-tune the fitment and eliminate any side-to-side play.

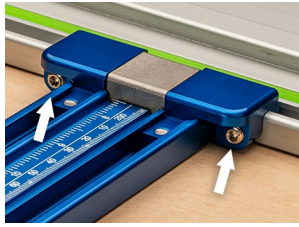

Step 1. With the parallel guide attached to your guide rail and laying flat, use the provided *3mm Hex Driver* to slowly tighten one of the nylon-tipped adjustment screws. While doing so, keep an eye on the far end of the *Parallel Guide Track*.



Step 2. As the screw is tightened, the end of the *Parallel Guide Track* will lift off your work surface slightly.

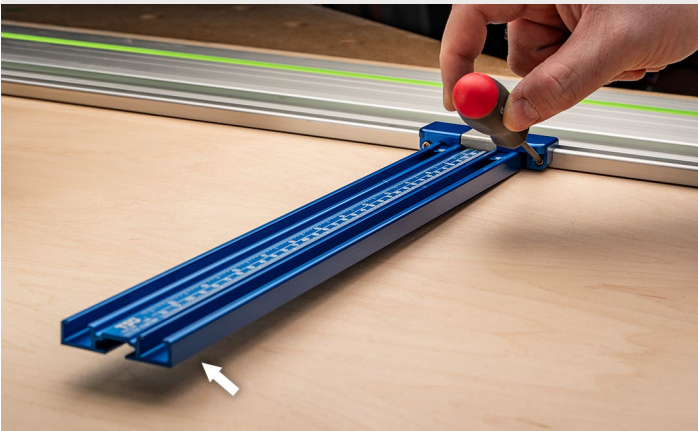

Step 3. Once this happens, slowly back off the screw until the track sits flush with your work surface.

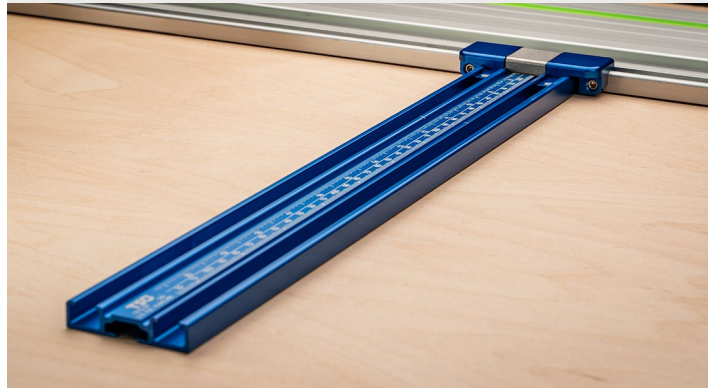

Step 4. Repeat this process for the other nylon-tipped adjustment screw on the *Drop-Loc Connector*.

Step 5. Repeat this process for each additional *Parallel Guide Track*.

★ PRO TIP: SLIDE WITHIN GUIDE RAIL

Once the adjustment screws are properly set, the *Parallel Guide Tracks* should not slide freely, even when the guide rail is held upright. To reposition a track without removing it from the guide rail, press the Drop-Loc button and/or slightly tilt the track upward to relieve clamping pressure, allowing smooth movement within the guide rail's T-track.



Calibrating Flip Stop Pro

★ PRO TIP: START WITH FRESH SPLINTERGUARD

For maximum calibration accuracy, start with a fresh or known-reliable splinterguard.

The splinterguard edge must align perfectly with your saw's kerf, as repeated use can cause wear. To check, make a test cut and feel along the splinterguard and workpiece. If the workpiece edge extends past the splinterguard, renew it.

Usually you don't need to replace it—just shift it out 1–2 mm and re-trim. Warm the adhesive with a heat gun or hair dryer, then peel it off carefully. The original adhesive often still holds; if not, 3M VHB 4910 or 5952 tape works well.



Step 1. Slide the *Flip Stop Pro* onto the *Parallel Guide Track*.



Step 2. Position the cursor to a desired calibration dimension (e.g. 10") and tighten the knob of the *Flip Stop Pro* to prevent movement during calibration.



Step 3. Using a trusted measurement instrument (e.g. combination square or double square), set it to the same dimension you selected in Step 2. Extend the square over the guide rail and place its reference edge firmly against the splinterguard, ensuring the tool blade remains perpendicular to the guide rail. *Note: If you don't have access to a tool for calibration, a panel cut to a known accurate size (e.g. 10" x 10") is an acceptable alternative.*



Step 4. Using the included 3mm Hex Driver, turn the calibration plunger on the *Flip Stop Pro* arm (clockwise to extend and counterclockwise to retract) until the plunger meets the reference surface. The *Flip Stop Pro* is now calibrated. Repeat for additional *Flip Stop Pros*.



★ PRO TIP: DOUBLE CALIBRATION

To calibrate two *Flip Stop Pros* at once, slide both *Parallel Guide Tracks* side-by-side on the same guide rail. Extend the blade of your measurement instrument to touch both *Flip Stop Pro* plungers at once. Quickly adjust the plunger of both *Flip Stop Pros* using the *3mm Hex Driver* and you're ready to cut.

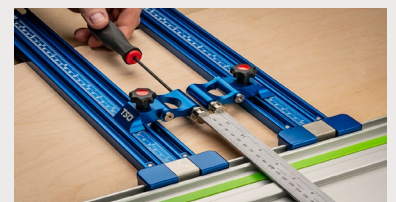

PARALLEL GUIDE SYSTEM GEN 2 USER GUIDE

TSO™ PRODUCTS

Installing the Guide Rail Square Connector

Available as an optional accessory, the *Guide Rail Square Connector* preserves the ability to use a *GRS-16* to connect the *Parallel Guide Tracks* to your guide rail, in place of a *Drop-Loc Connector*.

Step 1. Attach the *Guide Rail Square Connector* to your *GRS-16* using the provided *Flat Head Screws*.



Step 2. Loosen the torpedo nut on the underside of the *Guide Rail Square Connector* and slide the *Parallel Guide Track* through it.

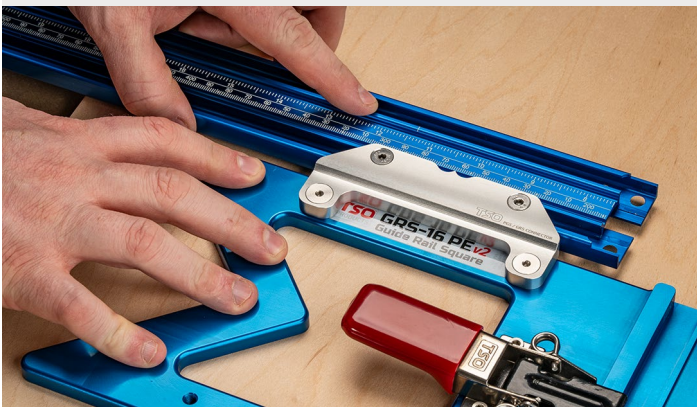

Step 3. Align the machined cursor of the *Guide Rail Square Connector* to the engraved lines on the *Parallel Guide Track*.



Step 4. Using the included *3mm Hex Driver*, tighten the two additional screws on the track side of the connector.



Step 5. Mount the *GRS-16* to your guide rail and install *Flip Stop Pro*.



Step 6. Calibrate the *Flip Stop Pro* before first use, following the process outlined on Page 5.

Questions, Comments, or Ideas?

We thrive on your feedback, so please let us know if you have any comments, concerns, feedback, or ideas on how we can continuously improve our products.

We're easy to reach! In the United States, call us toll-free at 800-727-0311. For our international customers, call us at 239-236-5526. To send us a message, visit us at www.tsoproducts.com or email info@tsoproducts.com, and we'll get back to you as soon as possible.

Festool is a registered trademark of TTS Tooltechnic Systems AG & Co. KG. *Makita*, *Milwaukee*, *RIDGID*, *Kreg*, *Powertec*, and *WEN* are trademarks or registered trademarks of their respective owners. All trademarks are the property of their respective companies and are used for reference purposes only.

Happy woodworking!